

SUPERFLOAT™ Float Drums

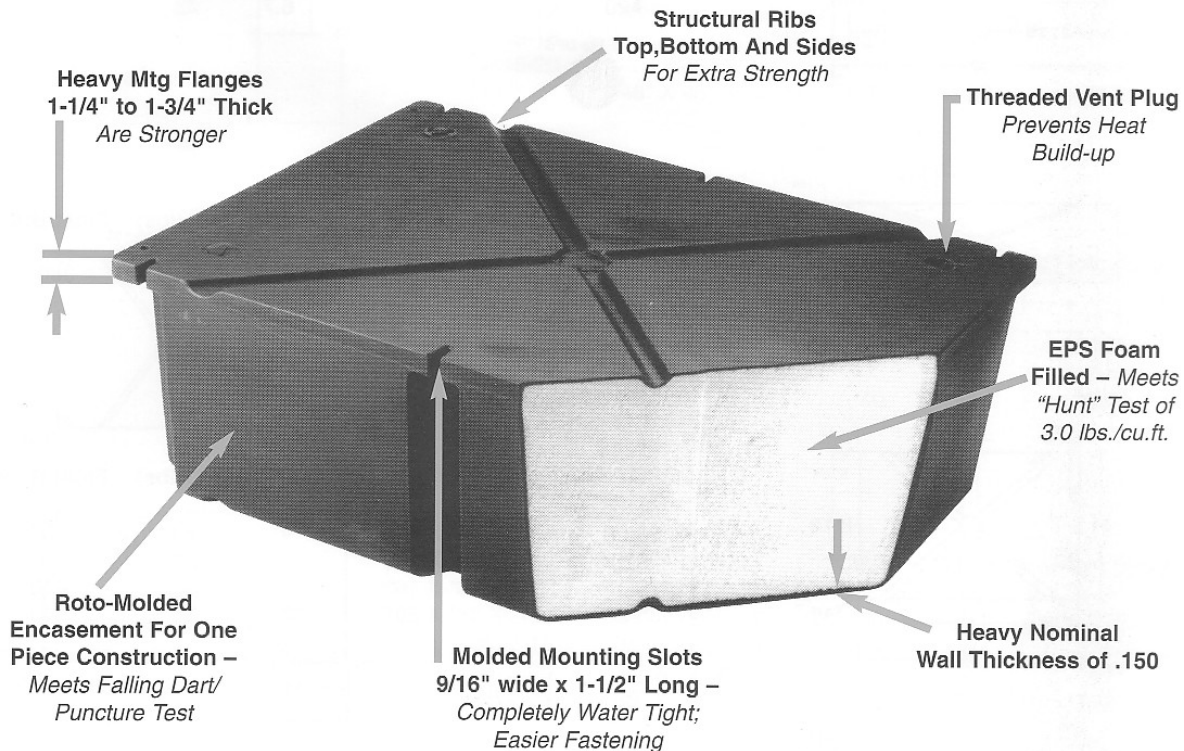

SUPERFLOAT™ FLOAT DRUMS (Manufactured by Ace Rotomold)

All units are manufactured from linear virgin polyethylene resin containing UV inhibitors and carbon black pigment to protect against ultra violet deterioration. These resins offer a balance of toughness, rigidity, environmental stress crack resistance and low temperature impact performance. Resin is also in compliance with the FDA title 12. This is a food grade material that will not contaminate the waterways. All float drums are rotational molded for seamless one-piece construction. The encasement meets the “Hunt” Falling Dart/Puncture and Thickness Test – resistant to damage by animals and will not sink or contaminate the water when punctured. The content of the encasement meet the “Hunt” Water Absorption Test – content is foam bead (EPS) flotation with a 1.0-1.5 lbs. Per cubic foot density with water absorption not to exceed 3 lbs. per cubic foot. Nominal wall thickness is 0.150 on all flotation encasements. Thicker walls available as special order. Resin will exhibit resilience against ice, bumps by watercraft, and contact deterioration from petroleum products. The encasement is recyclable.



HENDERSON MARINE SUPPLY, INC.
800-523-1586 www.hendersonmarine.com

*Specifications subject to change without notice. Not responsible for rust.
Liability limited to product replacement at the option of Henderson Marine Supply, Inc.
Not responsible for any inaccuracies in specifications.*

Page 01-1
Last Updated: 1/30/2008 4:58:00 PM

SUPERFLOAT™ Float Drums

Specifications and Ordering Information:

<u>MODEL</u>	<u>SIZE-(inches)</u>	<u>Cubic Feet</u>	<u>WT.-lbs</u>	<u>Buoyancy</u>
#1248-20	12*48*20 *	6.7	28	345
#1848-36	18*48*36 *	18	47	920
#2072-08	20*72*08 *	6.7	35	343
#2096-10	20*96*10 *	11	48	591
#2436-08	24*36*08 *	4	23	215
#2436-12	24*36*12 *	6	27	316
#2436-16	24*36*16 *	8	31	424
#2436-20	24*36*20 *	10	36	538
#2448-08	24*48*8 *	5.3	26	285
#2448-12	24*48*12 *	8	32	433
#2448-12 VF	24*48*12 *	7.5	32	409
#2448-16	24*48*16 *	10.7	38	585
#2448-16 VF	24*48*16	10.2	38	546
#2448-20	24*48*20	13.3	44	730
#2448-24	24*48*24	16	50	850
#2448-36	24*48*36	24	70	1314
#2496-08	24*96*8	11	52	555
#2496-12	24*96*12	16.1	64	839
#3648-12	36*48*12	12	43	656
#3648-16	36*48*16	16	52	860
#3648-18	36*48*18	18.2	59	982
#3648-20	36*48*20	20	64	1066
#3648-24	36*48*24	24	74	1270
#3648-32	(.175 wall)	32	80	1608
#3672-12	36*72*12	18	65	980
#3672-16	36*72*16	24	78	1320
#3672-20	36*72*20	30	90	1638
#3672-24	36*72*24	36	105	1915
#3672-32	(.175 wall)	48	115	2544
#3696-12	36*96*12	24	89	1337
#3696-16	36*96*16	32	104	1723
#3696-20	36*96*20	40	114	2157
#3696-24	36*96*24	48	129	2498
#3696-32	36*96*32	64	152	3193
#3878-12	38*78*12	20.6	75	1135
#4272-12	42*72*12	19.5	70	1159

* Can be shipped via UPS.



HENDERSON MARINE SUPPLY, INC.
800-523-1586 www.hendersonmarine.com

*Specifications subject to change without notice. Not responsible for rust.
Liability limited to product replacement at the option of Henderson Marine Supply, Inc.
Not responsible for any inaccuracies in specifications.*

Page 01-1c
Last Updated: 1/30/2008 4:58:00 PM

SUPERFLOAT™ Float Drums

<u>MODEL</u>	<u>SIZE-(inches)</u>	<u>Cubic Feet</u>	<u>WT.-lbs</u>	<u>Buoyancy</u>
#4272-16	42*72*16	28	87	1538
#4848-12	48*48*12	16	56	890
#4848-16	48*48*16	21.3	68	1215
#4848-20	48*48*20	26.7	79	1478
#4848-24	48*48*24	32	93	1741
#4848-32	(.175 wall)	43	106	2191
#4860-12	48*60*12	20	64	1100
#4860-16	48*60*16	26.7	81	1488
#4860-20	48*60*20	33.3	102	1855
#4860-24	48*60*24	40	114	2174
#4860-32	(.175 wall)	53.3	130	2800
#4872-12	48*72*12	24	83	1350
#4872-16	48*72*16	32	98	1769
#4872-20	48*72*20	40	113	2266
#4872-24	48*72*24	48	132	2660
#4872-28	48*72*28	56	141	3042
#4872-32	(.175 wall)	64	172	3365
#4896-12	48*96*12	32	110	1803
#4896-16	48*96*16	42.7	134	2420
#4896-20	48*96*20	53.3	154	2990
#4896-24	48*96*24	64	176	3414
#4896-32	(.175 wall)	86	188	4585
2630-60AT	(.375 wall)	27.1	85	1000
3030-72ATsq	(.375 wall)	37.5	104	2150
3030-90AT	(.375 wall)	46.9	130	2000
3030-90ATsq	(.375 wall)	46.9	160	2600
3240-108AT	(.375 wall)	81.5	200	3700
3240-108ATsq	(.375 wall)	81.5	230	4500
4848-20ATsq	(.375 wall)	26.9	93	1304
3240-144ATsq	(.375 wall)	106.7	300	6600



HENDERSON MARINE SUPPLY, INC.
 800-523-1586 www.hendersonmarine.com

*Specifications subject to change without notice. Not responsible for rust.
 Liability limited to product replacement at the option of Henderson Marine Supply, Inc.
 Not responsible for any inaccuracies in specifications.*

Page 01-1c
 Last Updated: 1/30/2008 4:58:00 PM

SUPERFLOAT™ Models & Sizes

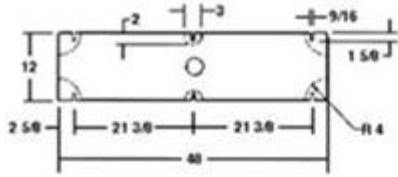

Model	Size (inches)	Cu.Ft.	Wt. (lbs)	Float Buoy.
* #1248-20	12" X 48" X 20"	6.7	28	340

* Models Ship Via UPS

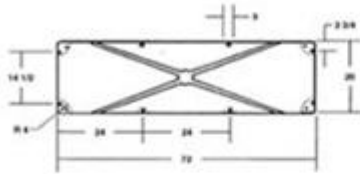

Model	Size (inches)	Cu.Ft.	Wt. (lbs)	Float Buoy.
* #2072-8	20" X 72" X 8"	6.7	35	380

* Models Ship Via UPS

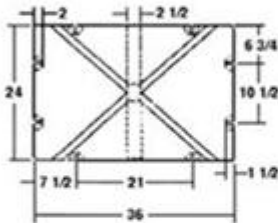

Model	Size (inches)	Cu.Ft.	Wt. (lbs)	Float Buoy.
* #2436-08	24" X 36" X 8"	4	23	230
* #2436-12	24" X 36" X 12"	6	26	335
* #2436-16	24" X 36" X 16"	8	32	440
* #2436-20	24" X 36" X 20"	10	36	540

* Models Ship Via UPS

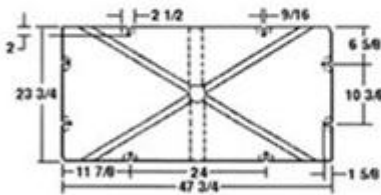

Model	Size (inches)	Cu.Ft.	Wt. (lbs)	Float Buoy.
* #2448-08	24" X 48" X 8"	5.3	26	310
* #2448-12	24" X 48" X 12"	8	32	450
* #2448-16	24" X 48" X 16"	10.7	38	590
* #2448-20	24" X 48" X 20"	13.3	44	725
* #2448-24	24" X 48" X 24"	16	50	860

* Models Ship Via UPS

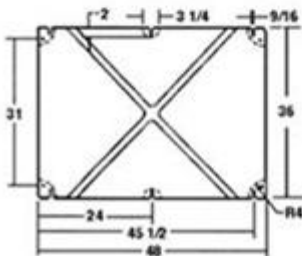

Model	Size (inches)	Cu.Ft.	Wt. (lbs)	Float Buoy.
#3648-12	36" X 48" X 12"	12	44	685
#3648-16	36" X 48" X 16"	16	54	900
#3648-20	36" X 48" X 20"	20	64	1110
#3648-24	36" X 48" X 24"	24	74	1315



HENDERSON MARINE SUPPLY, INC.
 800-523-1586 www.hendersonmarine.com

*Specifications subject to change without notice. Not responsible for rust.
 Liability limited to product replacement at the option of Henderson Marine Supply, Inc.
 Not responsible for any inaccuracies in specifications.*

SUPERFLOAT™ Models & Sizes

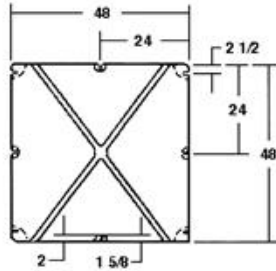

Model	Size (inches)	Cu.Ft.	Wt. (lbs)	Float Buoy.
#4848-12	48" X 48" X 12"	16	61	920
#4848-16	48" X 48" X 16"	21.3	71	1215
#4848-20	48" X 48" X 20"	26.7	81	1500
#4848-24	48" X 48" X 24"	32	93	1775

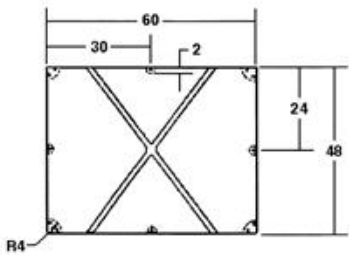

Model	Size (inches)	Cu.Ft.	Wt. (lbs)	Float Buoy.
#4860-12	48" X 60" X 12"	20	70	1155
#4860-16	48" X 60" X 16"	26.7	84	1525
#4860-20	48" X 60" X 20"	33.3	98	1885
#4860-24	48" X 60" X 24"	40	114	2235

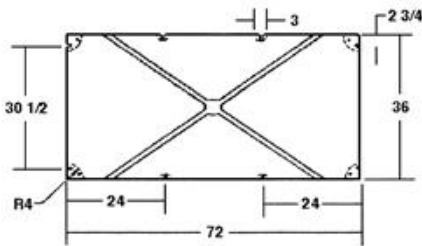

Model	Size (inches)	Cu.Ft.	Wt. (lbs)	Float Buoy.
#3672-12	36" X 72" X 12"	18	68	1035
#3672-16	36" X 72" X 16"	24	80	1365
#3672-20	36" X 72" X 20"	30	92	1685
#3672-24	36" X 72" X 24"	36	105	1995

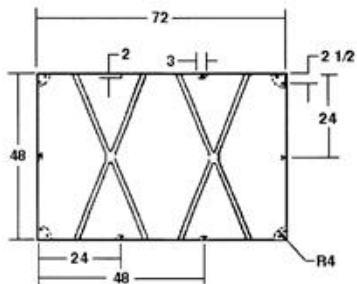

Model	Size (inches)	Cu.Ft.	Wt. (lbs)	Float Buoy.
#4872-12	48" X 72" X 12"	24	85	1390
#4872-16	48" X 72" X 16"	32	100	1835
#4872-20	48" X 72" X 20"	40	115	2270
#4872-24	48" X 72" X 24"	48	132	2695
#4872-32	48" X 72" X 32"	64	170	3615

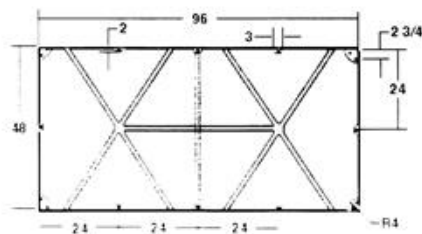

Model	Size (inches)	Cu.Ft.	Wt. (lbs)	Float Buoy.
#4896-12	48" X 96" X 12"	32	112	1855
#4896-16	48" X 96" X 16"	42.7	134	2455
#4896-20	48" X 96" X 20"	53.3	156	3040
#4896-24	48" X 96" X 24"	64	176	3615



HENDERSON MARINE SUPPLY, INC.
 800-523-1586 www.hendersonmarine.com

*Specifications subject to change without notice. Not responsible for rust.
 Liability limited to product replacement at the option of Henderson Marine Supply, Inc.
 Not responsible for any inaccuracies in specifications.*